

Recessed Incandescent

VS6

6" Versatile Slope PAR30/PAR38 Recessed Sloped Ceiling Housing



application

- For ceiling slopes from 2/12 to 12/12. Thermally protected, recessed housings. Furnished with pre-installed BH1 adjustable bar hangers. Junction box is provided with 1/2" conduit knockouts and 4 Romex knockouts with a strain relief. Fixtures are c/ETL listed for through-branch circuit wiring and damp location use. AirSeal™ housing meets all VSEC requirements and is tested to ASTM E238.

construction

- Housing** - Formed 20 gauge housing. Mounting frame is lightweight and easy to install. Housing is IC, non-IC and AirSeal™ rated. The neck is adjustable to accept a wide variety of ceiling thicknesses from 1/2" to 1-1/4". The junction box is accessible from below the ceiling.
- Socket** - Medium base screw shell porcelain socket.
- Adjustable Socket Bracket** - The versatile socket bracket allows for aiming of the lamp in ceiling pitches from 2/12 to 12/12. The socket can be easily positioned prior to installation due to the clearly marked pitch positions. Once aimed, the bracket locks in place with a single wing nut.
- Bar Hangers** - Furnished with BH1 bar hangers that telescope from 10-1/2" to 25". Vertical design of interlocking bar hangers prevents sagging even at full 24" extension. Bar hangers can be locked into position.
- Junction Box** - Large 32 cubic inch 16 gauge galvanized steel with two snap on covers and grounding pig tail. Knockouts for 1/2" and 3/4" conduit and 4 Romex knockouts with strain relief. Meets all safety requirements of c/ETL and the N.E.C.

- Thermal Protection** - Standard thermal protection device inside housing automatically takes fixture out of service if temperature becomes excessive from contact with insulation, overlampping, or wrong lamp/trim combination.
- AirSeal™ - Luminaire** is AirSeal™ rated, and tested per ASTM E283, limiting the passage of air through the housing to no more than 2.0 CFM at 75 Pascals. AirSeal™ housing meets restricted airflow requirements of Washington State Energy Code (W.S.E.C.) and International Energy Conservation Code (I.E.C.C.)
- c/ETL Listed - for damp locations and through branch wiring, 3 in/3 out.

accessories (ordered separately)

- 27" Flat Bar Hanger BH3



Specifier's Reference

Project

Type

Model No.

Comments

Sample Catalog Number: VS6-VS640CLR

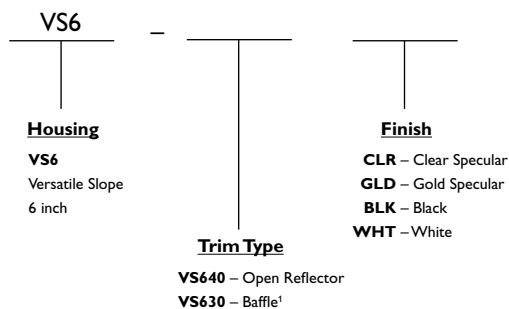

Foot Notes

- Baffle available in white or black only.

trims



VS630 (Shown)

Black Baffle

VS630WHT

White Baffle

7-3/4" O.D. (197 mm)

Lamp	IC	Non-IC
PAR30	75W	75W
PAR38	90W	150W



VS640CLR (Shown)

Specular Reflector

VS640GLD Gold Reflector

VS640BLK Black Reflector

VS640WHT White Reflector

7-3/4" O.D. (197 mm)

Lamp	IC	Non-IC
PAR30	75W	75W
PAR38	90W	150W

dimensions

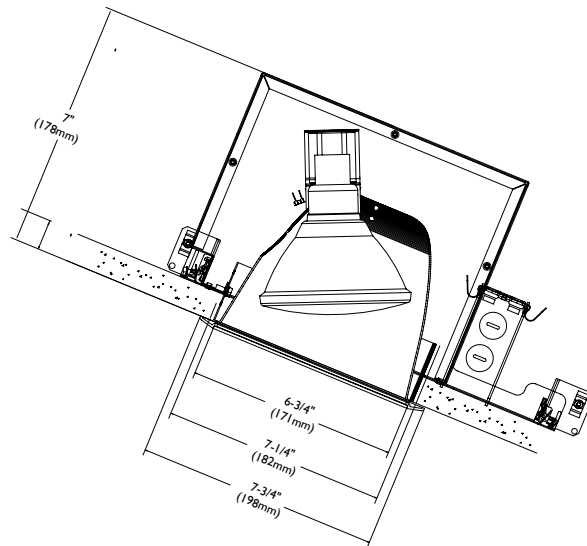
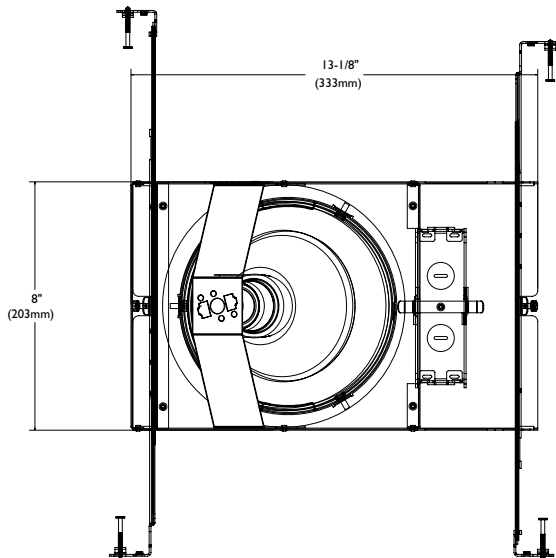

VS6-VS640WHT 2/12 PITCH

Report number: 28480
Lamp: (1)90W PAR38
S/MH Ratio
(0 degree plane): 1.1
(90 degree plane): 0.2
Total Fixture Lumens: 918
IES file: 28480.IES
Beam Angle: 35.46
Fixture Efficiency: 68.0%

Candle Power			
DEGREES	CANDELA		FOOT-LAMBERTS
	AT 0°	AT 90°	
90	0	1	
85	1	1	138
75	3	2	139
65	11	8	350
55	26	18	614
45	73	53	1426
35	254	190	
25	1524	309	
15	2370	506	
5	2145	721	
0	1377	1377	

Lighting Performance Data

Ceiling Height	Initial Beam	
	Footcandles	Diameter (FT-IN)
8	45.5	3 - 6
10	24.5	4 - 10
12	15.3	6 - 1
14	10.4	7 - 4
16	7.6	8 - 8

Coefficients of Utilization

RC	80	70	50
RW	50	30	50
0	64	64	63
1	57	56	56
2	54	48	51
3	46	42	46
4	41	38	40
5	38	33	36
6	34	29	34
7	30	27	30
8	28	23	28
9	26	22	26
10	23	20	23

VS6-VS640WHT 6/12 PITCH

Report number: 28475
Lamp: (1)90W PAR38
S/MH Ratio
(0 degree plane): 1.6
(90 degree plane): 0.7
Total Fixture Lumens: 785
IES file: 28475.IES
Beam Angle: 66.44
Fixture Efficiency: 58.1%

Candle Power			
DEGREES	CANDELA		FOOT-LAMBERTS
	AT 0°	AT 90°	
90	0	0	
85	0	0	0
75	0	0	93
65	37	24	1155
55	235	292	7350
45	549	645	13509
35	654	690	
25	678	564	
15	613	680	
5	679	714	
0	697	697	

Lighting Performance Data

Ceiling Height	Initial Beam	
	Footcandles	Diameter (FT-IN)
8	23.0	14-10
10	12.4	20-3
12	7.7	25-7
14	5.3	30-12
16	3.8	36-5

Coefficients of Utilization

RC	80	70	50
RW	50	30	50
0	64	64	63
1	57	56	56
2	54	48	51
3	46	42	46
4	41	38	40
5	38	33	36
6	34	29	34
7	30	27	30
8	28	23	28
9	26	22	26
10	23	20	23

VS6-VS640WHT 12/12 PITCH

Report number: 28482
Lamp: (1) 90W PAR38
S/MH Ratio
(0 degree plane): 2.7
(90 degree plane): 1.4
Total Fixture Lumens: 883
IES file: 28482.IES
Beam Angle: 102.36
Fixture Efficiency: 65.4%

Candle Power			
DEGREES	CANDELA		FOOT-LAMBERTS
	AT 0°	AT 90°	
90	1	5	
85	2	6	688
75	8	9	525
65	24	24	909
55	190	59	3473
45	1199	130	15030
35	2158	177	
25	1462	168	
15	324	163	
5	206	177	
0	185	185	

Lighting Performance Data

Ceiling Height	Initial Beam	
	Footcandles	Diameter (FT-IN)
8	6.1	13 - 8
10	3.3	18 - 8
12	2.0	23 - 7
14	1.4	28 - 7
16	1.0	33 - 7

Coefficients of Utilization

RC	80	70	50
RW	50	30	50
0	78	78	78
1	72	70	68
2	68	63	59
3	63	56	53
4	57	51	46
5	54	46	40
6	50	41	35
7	46	38	32
8	42	34	28
9	40	30	26
10	36	28	23



©2011 Philips Omega
 All rights reserved.
 776 South Green Street • Tupelo, MS 38804
 p. 800.234.1890 • f. 662.841.5501
 www.omegalighting.com
 Canadian Division
 189 Bullock Drive • Markham, Ontario L3P 1W4
 p. 905.294.9570 • f. 905.294.9811

Contact Factory for Additional Configurations.
 Specifications are subject to change without notice.



Some luminaires use fluorescent or high intensity discharge (HID) lamps that contain small amounts of mercury. Such lamps are labeled, "Contain Mercury" and/or the symbol "HG". Lamps that contain mercury must be disposed of in accordance with local requirements. Information regarding lamp recycling and disposal can be found at www.lamprecycle.org