

FBF FLUORESCENT HIGH BAY LUMINAIRE

T8 or T5/HO Fluorescent

The FBF Fluorescent High Bay Luminaire features Miro 4 reflectors and a solid enclosure design for an efficient alternative in industrial lighting applications. The FBF features a field adjustable uplight (patent pending) for application versatility.

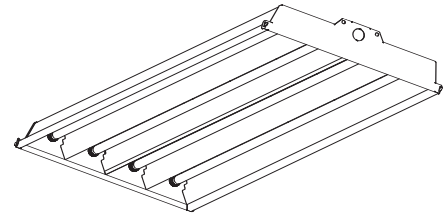

JOB NAME _____

TYPE _____

ORDERING MATRIX

SAMPLE CATALOG NUMBER: FBF654HO-UNV-1/42-EB-U

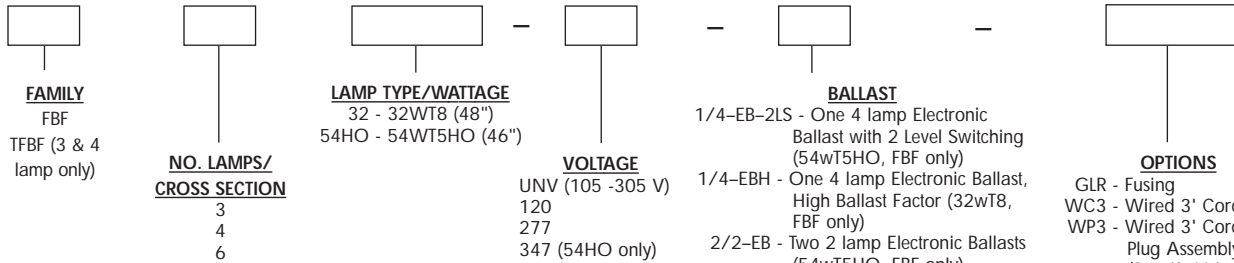

FAMILY
FBF
TFBF (3 & 4 lamp only)

**NO. LAMPS/
CROSS SECTION**
3
4
6

LAMP TYPE/WATTAGE
32 - 32WT8 (48")
54HO - 54WT5HO (46")

VOLTAGE
UNV (105 -305 V)
120
277
347 (54HO only)
480 (54HO: 1/4-EB, 1/42-EB and 2/4-EB only or 32T8: 2/3-EBH and 2/2-EBH only)

BALLAST
1/4-EB-2LS - One 4 lamp Electronic Ballast with 2 Level Switching (54wT5HO, FBF only)
1/4-EBH - One 4 lamp Electronic Ballast, High Ballast Factor (32wT8, FBF only)
2/2-EB - Two 2 lamp Electronic Ballasts (54wT5HO, FBF only)
2/2-EBH - Two 2 lamp Electronic Ballasts, High Ballast Factor (32wT8, FBF only)
2/3-EBH - Two 3 Lamp Electronic Ballasts, High Ballast Factor (32wT8 only)
3/2-EBH - Three 2 Lamp Electronic Ballasts, High Ballast Factor (32wT8 only)
1/42-EBH - One 4 lamp and one 2 lamp Electronic Ballast, High Ballast Factor (32wT8 only)
1/42-EB - One 4 lamp and one 2 lamp Electronic Ballast (54wT5HO only)
2/4-EB - Two 4 lamp Electronic Ballasts (TFBF with 54W T5HO only)
4/2-EBH - Four 2 lamp Electronic Ballasts, High Ballast Factor (TFBF with 32W T8 only)

OPTIONS
GLR - Fusing
WC3 - Wired 3' Cord
WP3 - Wired 3' Cord and Plug Assembly (Specify Voltage)
U - Uplight
PAF - Painted After Fabrication
WT - Optional White Reflector
HS - Hang Straight (req'd when using PENHGR and a hook)

ACCESSORIES (ORDER SEPARATELY)

- WG-FBF4 - 4 Lamp Wire Guard (2 required for TFBF)
- WG-FBF6 - 6 Lamp Wire Guard
- MD360 - Motion Detector (120-277)
- MD360-480 - Motion Detector (480)
- FBF-PENHGR - Pendant Hanger (4 ft. unit only)
- FBF-JB - Junction Box. Use with FBF PENHGR to conceal wiring
- FBF-4E-1W - Single gasketed enclosure with clear acrylic lens-4 lamp unit (4 ft. unit only)
- FBF-4E-2W - Double gasketed enclosure with clear acrylic lens-4 lamp unit (4 ft. unit only)
- FBF-6E-1W - Single gasketed enclosure with clear acrylic lens-6 lamp unit (4 ft. unit only)
- FBF-6E-2W - Double gasketed enclosure with clear acrylic lens-6 lamp unit (4 ft. unit only)

NOTE: Add "DB21" to enclosure catalog number for prismatic lens.

General Notes:
All options factory installed.
All accessories are field installed.
Uplight is not field adjustable on 3 lamp TFBF.

ENERGY DATA

LAMP WATTS	BALLAST TYPE	INPUT WATTS
32	1/4-EBH	146
	2/2-EBH	148
	2/3-EBH	222
	3/2-EBH	231
	1/42-EBH	220
54	4/2-EBH	296
	1/4-EB-2LS	240
	2/2-EB	236
	1/42-EB	358
	2/4-EB	480

DIMENSIONS

6 LAMP

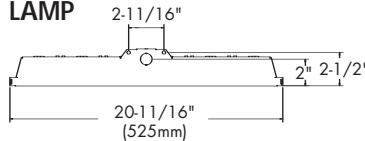

4 LAMP

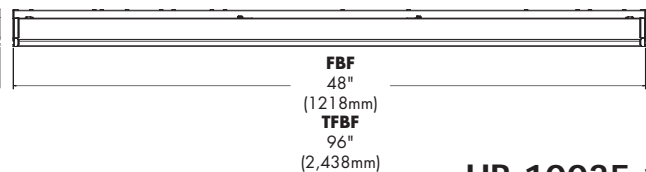
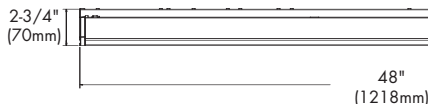
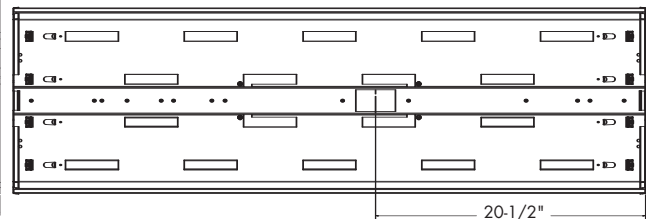
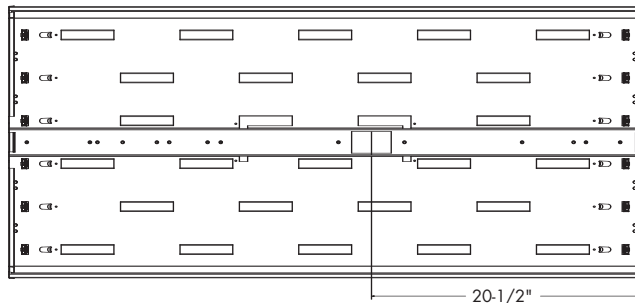
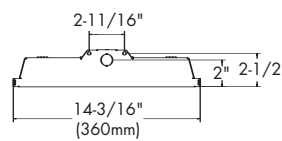

HB-10035.1

PHOTOMETRICS

4-F54T5HO with UPLIGHT

MEDIUM SPREAD S/MH = 1.1

TEST NO. 25219

DISTRIBUTION CURVE	COEFFICIENTS OF UTILIZATION										AVERAGE BRIGHTNESS				ZONAL SUMMARY				CANDLEPOWER			
	EFFECTIVE FLOOR CAVITY REFLECTANCE 20 PER (pfc=0.20)										ZONE	END	45	CROSS	Degrees	Lumens	% Lamp	% Fixture	Angle	End	45°	Cross
	Ceil	80	70	50	30	10	45	16856	12581	9533	0-30	5671	32.2	34.5	0	7700	7700	7700				
	Wall	70	50	30	10	50	55	15910	8666	3290	0-40	8911	50.6	54.2	5	7667	7708	7662				
	RCR	0	109	109	109	106	106	106	99	99	93	93	93	87	87	87	15	7374	7387	7049		
	1	102	98	95	92	98	95	92	90	90	87	85	85	83	81	80	25	6802	6114	5765		
	2	94	88	83	78	91	85	81	77	81	77	74	76	73	71	72	35	5963	5148	4538		
	3	87	79	72	67	84	77	71	66	73	68	64	69	65	62	66	45	4983	3719	2818		
	4	80	71	64	58	78	69	63	58	66	60	56	63	58	54	60	55	3815	2078	789		
	5	75	64	57	51	72	63	56	51	60	54	49	57	52	48	54	65	2528	390	1		
	6	69	58	51	46	67	57	50	45	54	48	44	52	47	43	50	75	1220	14	2		
	7	64	53	46	41	62	52	45	40	50	44	39	48	43	39	46	85	226	10	4		
	8	60	49	42	37	58	48	41	36	46	40	36	44	39	35	42	COMPARATIVE YEARLY LIGHTING ENERGY COST PER 1000 LUMENS = \$3.48 BASED ON 3000 HRS. AND \$.08 PER KWH. LER=69					
9	56	45	38	33	55	44	38	33	43	37	32	41	36	32	39	These photometric results were obtained in the Day-Brite Lighting Laboratory which is NVLAP accredited by the National Institute of Standards and Technology.						
10	53	42	35	30	51	41	35	30	39	34	30	38	33	29	37							

ADDITIONAL TEST NUMBERS

DESCRIPTION/CATALOG NUMBER	TEST NUMBER
FBF454HO-UNV-2/2-EB	25193
FBF454HO-UNV-2/2-EB-U-WT	25103
FBF454HO-UNV-2/2-EB-WT	25098

ADDITIONAL TEST NUMBERS (CONT'D)

DESCRIPTION/CATALOG NUMBER	TEST NUMBER
FBF432-UNV-2/2-EBH-U	25354
FBF432-UNV-2/2-EBH	25355
FBF432-UNV-2/2-EBH-U-WT	25359
FBF432-UNV-2/2-EBH-WT	25356

6-F54T5HO with UPLIGHT

MEDIUM SPREAD S/MH = 1.0

TEST NO. 25362

DISTRIBUTION CURVE	COEFFICIENTS OF UTILIZATION										AVERAGE BRIGHTNESS				ZONAL SUMMARY				CANDLEPOWER			
	EFFECTIVE FLOOR CAVITY REFLECTANCE 20 PER (pfc=0.20)										ZONE	END	45	CROSS	Degrees	Lumens	% Lamp	% Fixture	Angle	End	45°	Cross
	Ceil	80	70	50	30	10	45	15195	10973	8253	0-30	8103	30.7	33.6	0	11113	11113	11113				
	Wall	70	50	30	10	50	55	14285	7360	3949	0-40	12733	48.2	52.8	5	11068	11115	11014				
	RCR	0	106	106	106	103	103	103	96	96	96	96	90	90	90	15	10661	10422	9822			
	1	99	96	93	90	96	93	90	87	87	85	83	82	80	79	78	25	9888	8580	8234		
	2	92	85	80	76	88	83	78	74	78	74	71	74	71	68	70	35	8749	7283	6517		
	3	85	76	70	65	82	74	69	64	70	66	62	67	63	59	63	45	7320	5286	3976		
	4	78	69	62	56	75	67	61	56	64	58	54	60	56	52	58	55	5582	2876	1543		
	5	72	62	55	50	70	61	54	49	58	52	48	55	50	46	52	65	3677	731	171		
	6	67	56	49	44	65	55	48	43	53	47	42	50	45	41	48	75	1727	22	7		
	7	63	51	44	39	61	50	44	39	48	42	38	46	41	37	44	85	249	17	11		
	8	58	47	40	35	57	46	40	35	44	38	34	43	37	34	41	COMPARATIVE YEARLY LIGHTING ENERGY COST PER 1000 LUMENS = \$3.53 BASED ON 3000 HRS. AND \$.08 PER KWH. LER=68					
9	55	44	37	32	53	43	36	32	41	35	31	39	34	31	38	These photometric results were obtained in the Day-Brite Lighting Laboratory which is NVLAP accredited by the National Institute of Standards and Technology.						
10	51	40	34	29	50	40	33	29	38	32	28	37	32	28	35							

ADDITIONAL TEST NUMBERS

DESCRIPTION/CATALOG NUMBER	TEST NUMBER
FBF654HO-UNV-1/42-EB	25363
FBF654HO-UNV-1/42-EB-U-WT	25367
FBF654HO-UNV-1/42-EB-WT	25364

ADDITIONAL TEST NUMBERS (CONT'D)

DESCRIPTION/CATALOG NUMBER	TEST NUMBER
FBF632-UNV-2/3-EBH-U	25345
FBF632-UNV-2/3-EBH	25346
FBF632-UNV-2/3-EBH-U-WT	25351
FBF632-UNV-2/3-EBH-WT	25348

PRODUCT FEATURES

UL 1598 Listed suitable for damp location and 40°C ambient.

- Optional heavy duty mounting chains and hangers (ordered separately). Order (2) DACH-(LENGTH) if cable hangers are required.
- Miro 4 reflectors maximize luminaire efficiency and control light distribution.
- Steel housing is multi-stage phosphate treated for maximum corrosion resistance and finish coat is high reflectance baked white enamel.
- Electronic ballast(s).
- Uplight apertures in housing and reflectors. These are in closed position unless the "U" option is specified. Uplight is field adjustable by rotating reflectors 180° along the axis of the luminaire. (patent pending)
- Rotating ring, locking type lampholders for T5 HO lamps and locking type for T8 lamps.
- End holes to attach hanger for chain.
- Wiring access plate.
- 7/8" K.O. for wiring or motion detector.

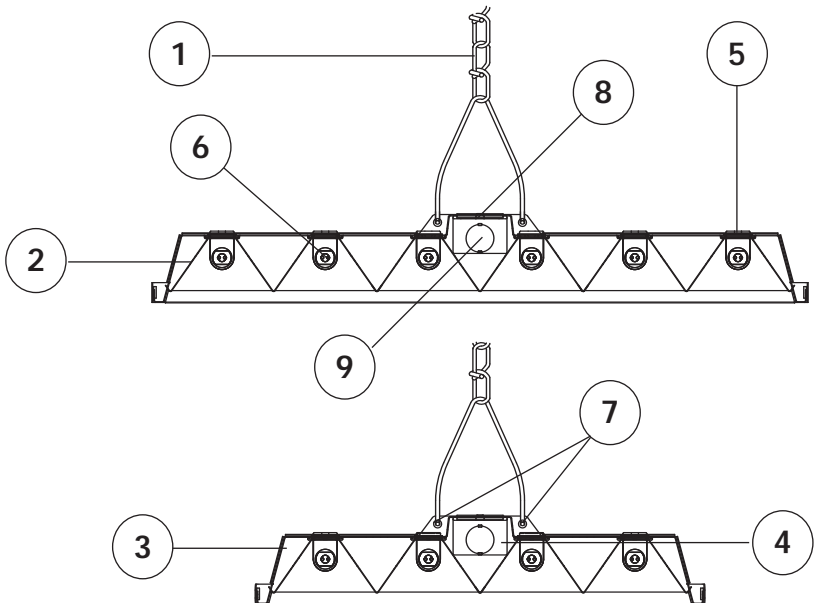

Visit our web site at www.daybritelighting.com

HB-10035.1

776 South Green Street Tupelo, MS 38804 Phone: 662-842-7212 Fax: 662-841-5501
 189 Bullock Drive Markham, Ontario Canada L3P 1W4 Phone: 905-294-9570 Fax: 905-294-8911
 Day-Brite Lighting reserves the right to make changes without notice. © July 2006

